

# ENFORCER®

## Access

### Electric Deadbolt for Fail-Secure Applications

Model: SD-997A

Adds concealed deadbolt security to most wood or hollow metal doors, with the added convenience of electrical operation.

#### Features:

- ▶ Fail-secure operation (locks if power is lost).
- ▶ Stainless steel bolt, 5/8" diameter, 5/8" throw.
- ▶ Includes control wire which allows for releasing without cutting unit's power.
- ▶ Door open/close monitor (NO/C/NC).
- ▶ Magnetic switch senses door position for positive locking.
- ▶ Solenoid attempts to lock several times and then shuts down if door not closed properly to prevent solenoid from burning out. Once door closed properly will automatically lock.
- ▶ Adjustable door lock delay timer - (0, 3, 5, or 9 seconds).
- ▶ 1.5-Amp over-current protection.
- ▶ Includes all necessary hardware.

**SD-997B** - Similar to SD-997A but for Fail Safe operation (also does not include locking cylinder or second wire connector).

#### Dimensions:\*

\* Note: Inches are closest 1/16" approximation.

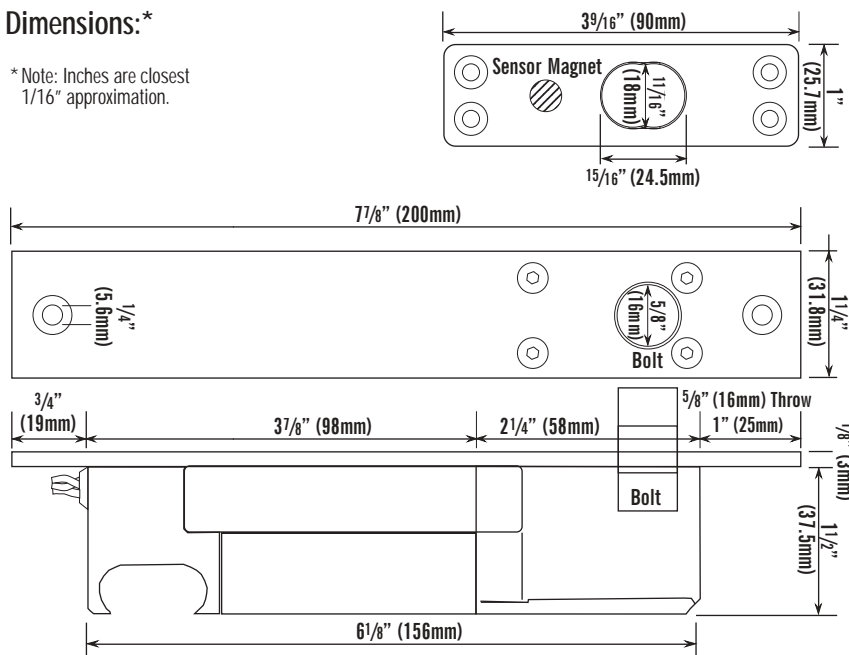

Note that cylinder extends past lock on both sides.

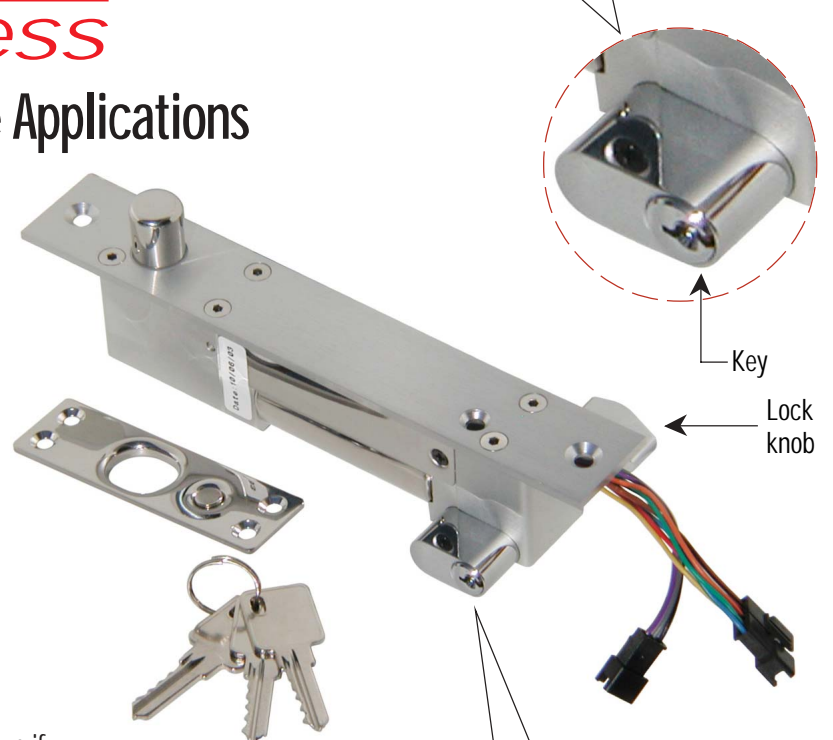

#### Connection Diagram:

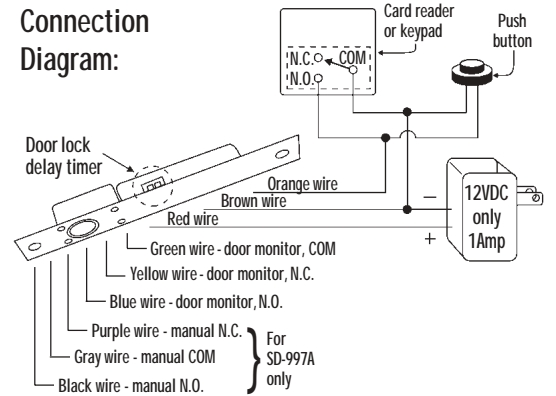

#### Specifications:

	SD-997A	SD-997B
Operation	Fail-Secure	Fail-Safe
Current Draw	Standby: 320mA Activated: 880mA	Standby: 360mA Activated: 900mA
Status Sensor	SPDT, 500mA @ 12VDC (N.O./C./N.C.)	
Operation Voltage	12VDC	
Adjustable Delay Timer	0, 3, 5, 9 sec.s	0, 2.5, 5, 9 sec.s
Weight (approx.)	2lbs., 5oz. (1kg)	1lb., 13oz. (0.82kg)

SD997A.pmd

The SECO-LARM policy is one of continual development. For that reason, SECO-LARM reserves the right to change prices and specifications without notice. SECO-LARM is not responsible for misprints.